

Steel Strap
for Tubes of NW 20 to 500

DIN
3570

Rundstahlbügel für Rohre von NW 20 bis 500

Dimensions in mm

Type A
for tubes of all nominal widths

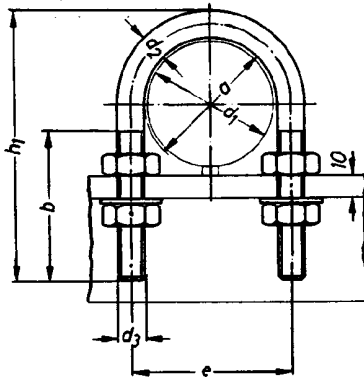

Type B
for tubes of nominal widths up to 80

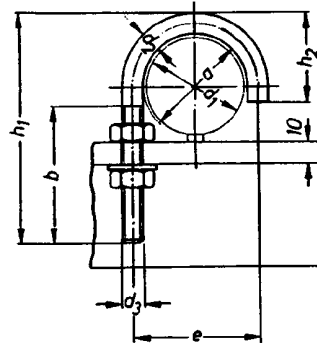

Designation of a steel strap Type A with inside diameter $a = 82$ mm without nuts and washers:

Steel strap A 82 DIN 3570

(The associated nuts and washers are to be ordered separately.)

a ¹⁾	For use with tubes of		b ²⁾	d ₂	d ₃	e	h ₁ ²⁾	h ₂	Weight (7,85 kg/dm ³) kg/100 pieces																		
	d ₁	Nominal width							A	B																	
30	25	20	3/4"	40	10	M 10	40	70	28	9,4	6,8																
	26,9																										
38	30	25	1"									50	12	M 12	48	76	31	10,5	7,7								
	33,7																										
46	38	32	1 1/4"																	50	12	M 12	56	86	37	12,0	9,0
	42,4																										
52	44,5	40	1 1/2"	50	12	M 12	62	92	40	12,9	9,7																
	48,3																										
64	57	50	2"									50	12	M 12	76	109	49	22,2	16,8								
	60,3																										
82	76,1	65	2 1/2"																	50	12	M 12	94	125	57	25,9	19,8
	88,9																										
94	88,9	80	3"	50	12	M 12	106	138	66	28,8	22,4																
	88,9																										

The weights are calculated for steel straps without nuts and washers.

- Corresponds approximately to the outside diameter of the associated tube plus the permissible dimension variations.
- b and h_1 are minimum dimensions and are based on a plate thickness of 10 mm. Dimensions differing from those listed in the Table are to be specifically indicated when ordering; in such cases, the designation of a steel strap Type A with inside diameter $a = 82$ mm and, for example, $h_1 = 130$ mm and $b = 55$ mm reads:

Steel strap A 82 x 130 x 55 DIN 3570

Continued on page 2

No guarantee can be given in respect of this translation
In all cases the latest German-language version of this standard shall be taken as authoritative

Nachdruck, auch auszugsweise, nur mit Genehmigung des Deutschen Normenausschusses, Berlin 30, gestattet.

a ¹⁾	For use with tubes of		b ²⁾	d ₂	d ₃	e	h ₁ ²⁾	Weight (7,85 kg/dm ³) kg/100 pieces A	
	d ₁	Nominal width							
120	108	100	4"	60	16	M 16	136	171	64,0
	114,3								
148	133	125	—				164	191	72,7
	139,7								
176	159	150	—				192	217	83,4
	168,3								
202	(191)	(175)	—				218	249	95,8
	193,7								
228	216	200	—				248	283	169,8
	219,1								
282	267	250	—	70	20	M 20	302	334	202,8
	273								
332	318	300	—				352	385	235
	323,9								
378	355,6	350	—	402	435	382			
	368								
428	406,4	400	—	24	M 24	452	487	429	
	419								
530	508	500	—			554	589	522	
	521								

Bracketed sizes should be avoided wherever possible

Material:

for steel strap: USt 37-1 according to DIN 17100

Round steel according to DIN 1013 shall be used for half-finished products

for nuts: Strength category 5 according to DIN 267 Sheet 4

¹⁾ and ²⁾ see on page 1

Washers according to DIN 126

Washers for channels and I-beams according to DIN 434 and 435

Nuts according to DIN 555